

Kabelverschraubung
SCHLEMMER-TEC
 Messing vernickelt
 metrisches Gewinde, kurz

Cable gland
SCHLEMMER-TEC
 nickel-plated brass
 metric thread, short

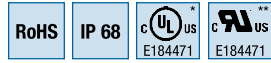

Material:

- 1/3: Verschraubungskörper/
Hutmutter: Messing vernickelt
- 2: Klemmkörper: Polyamid 6
- 4: Dichtring für Außengewinde:
Nitril
- 5: Dichtung: Neopren

Temperaturbereich:
 -40°C bis 100°C

Farbe(n)/Ausführungen:

- Außengewinde: Metrisch
- kurzes Gewinde
- Reduzier-Dichteinsatz

Eigenschaften:

- optimale Zugentlastung durch
Klemmlamellen
- gas- und wasserdicht
- zusätzlicher Dichtring (4) aus Nitril
am Verschraubungskörper

Zubehör (siehe Kapitel...):

- Gegenmuttern (3.3)
- Montagezange Mon.Za (3.1)

Anwendungsbereiche:

- Maschinen- und Anlagenbau
- Photovoltaik
- Automatisierungstechnik

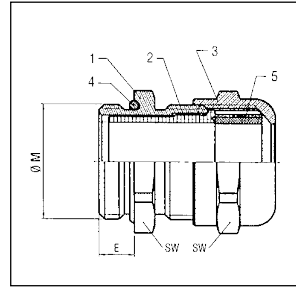

Material:

- 1/3: Gland element/Cap nut:
nickel-plated brass
- 2: Clamping shell: Polyamide 6
- 4: Sealing-Ring for External thread:
Nitrile
- 5: Sealing: Neoprene

Temperature range:
 -40°C to 100°C

Colour(s)/Designs:

- External thread: metric
- short thread
- reduction sealing insert

Characteristics:

- maximum strain relief through
clamp lamella
- gas and water-tight
- additional Nitrile sealing-ring (4)
on the gland element

Accessories (see chapter...):

- lock nuts (3.3)
- Mounting tool Mon.Za (3.1)

Applications:

- Machine and apparatus construction
- Photovoltaic
- Automation technology

2.1

| Außengewinde | Klemmbereich mm | Gewindelänge (E) mm | SW mm | Art.-Nr. vernickelt | VE Stck. |
|--|-------------------|----------------------|-------|------------------------|----------|
| External thread | Clamping range mm | Thread length (E) mm | SW mm | Art. no. nickel-plated | PU pcs. |
| M 12 x 1,5 ** | 2,5 - 6,5 | 5,0 | 14,0 | 4220612 | 50 |
| M 16 x 1,5 * | 4,0 - 9,5 | 5,0 | 17,0 | 4220616 | 50 |
| M 20 x 1,5 | 7,0 - 13,0 | 6,0 | 22,0 | 4220620 | 50 |
| M 25 x 1,5 | 8,0 - 16,0 | 7,0 | 27,0 | 4220625 | 25 |
| M 32 x 1,5 | 11,0 - 21,0 | 8,0 | 34,0 | 4220632 | 20 |
| M 40 x 1,5 | 15,0 - 27,0 | 8,0 | 42,0 | 4220640 | 10 |
| M 50 x 1,5 | 22,0 - 35,0 | 9,0 | 55,0 | 4220650 | 5 |
| M 63 x 1,5 | 35,0 - 48,0 | 10,0 | 65,0 | 4220663 | 5 |
| mit Reduzier-Dichteinsatz / with reduction sealing insert | | | | | |
| M 12 x 1,5 RED ** | 1,5 - 5,0 | 5,0 | 14,0 | 4220712 | 50 |
| M 16 x 1,5 RED * | 2,5 - 7,0 | 5,0 | 17,0 | 4220716 | 50 |
| M 20 x 1,5 RED | 4,0 - 10,0 | 6,0 | 22,0 | 4220720 | 50 |
| M 25 x 1,5 RED | 5,0 - 13,0 | 7,0 | 27,0 | 4220725 | 25 |
| M 32 x 1,5 RED | 7,0 - 17,0 | 8,0 | 34,0 | 4220732 | 20 |
| M 40 x 1,5 RED | 10,0 - 22,0 | 8,0 | 42,0 | 4220740 | 10 |
| M 50 x 1,5 RED | 17,0 - 29,0 | 9,0 | 55,0 | 4220750 | 5 |
| M 63 x 1,5 RED | 28,0 - 40,0 | 10,0 | 65,0 | 4220763 | 5 |

Gegenmuttern
Messing vernickelt
PG-/metrisches Gewinde

Lock nuts
nickel-plated brass
PG-/metric thread

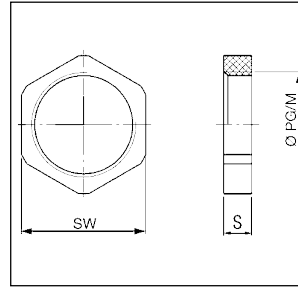

RoHS

Material:
Messing vernickelt
Farbe(n)/Ausführungen:
• Gewinde: PG/Metrisch

Eigenschaften:
• PG nach „alter“ DIN 46 320
Anwendungsbereiche:
• passend für PG/metrische Kabel- und Schlauchverschraubungen, sowie Zubehör

Material:
nickel-plated brass
Colour(s)/Designs:
• Thread: PG/metric

Characteristics:
• PG acc. to „old“ DIN 46 320
Applications:
• suitable for PG/metric Cable- and Conduit Glands as well as Accessories

2.3

| Gewinde Thread | Stärke (S) mm Thickness (S) mm | SW mm SW mm | Art.-Nr. vernickelt Art. no. nickel-plated | VE Stck. PU pcs. |
|---|---|----------------------|---|---------------------------|
| PG (nach „alter“ DIN 46 320) / PG (acc. to „old“ DIN 46 320) | | | | |
| PG 7 | 2,9 | 15,0 | 6000070 | 50 |
| PG 9 | 2,9 | 18,0 | 6000096 | 50 |
| PG 11 | 3,1 | 21,0 | 6000118 | 50 |
| PG 13,5 | 3,1 | 23,0 | 6000134 | 50 |
| PG 16 | 3,1 | 26,0 | 6000169 | 50 |
| PG 21 | 3,6 | 32,0 | 6000215 | 20 |
| PG 29 | 4,1 | 41,0 | 6000290 | 20 |
| PG 36 | 5,1 | 51,0 | 6000363 | 10 |
| PG 42 | 5,1 | 60,0 | 6000428 | 5 |
| PG 48 | 5,6 | 64,0 | 6000487 | 5 |
| Metrisch / metric | | | | |
| M 6 x 1,0 | 3,5 | 8,0 | 6004067 | 50 |
| M 8 x 1,25 | 3,5 | 11,0 | 6004083 | 50 |
| M 10 x 1,5 | 3,5 | 12,0 | 6004105 | 50 |
| M 12 x 1,5 | 3,0 | 15,0 | 6004121 | 50 |
| M 16 x 1,5 | 2,8 | 19,0 | 6004165 | 50 |
| M 16 x 1,5 | 3,0 | 20,0 | 6004164 | 50 |
| M 20 x 1,5 | 3,5 | 24,0 | 6004202 | 50 |
| M 25 x 1,5 | 3,5 | 30,0 | 6004253 | 25 |
| M 32 x 1,5 | 4,5 | 35,0 | 6004326 | 20 |
| M 40 x 1,5 | 4,5 | 45,0 | 6004407 | 10 |
| M 50 x 1,5 | 5,5 | 55,0 | 6004504 | 10 |
| M 63 x 1,5 | 6,0 | 70,0 | 6004636 | 5 |
| M 75 x 1,5 | 8,0 (10,0) | 80,0 | 6004750 | 1 |
| M 80 x 2,0 XXL | 10,0 | 95,0 | 6004752 | 5 |
| M 90 x 2,0 XXL | 10,0 | 100,0 | 6004754 | 5 |
| M 100 x 2,0 XXL | 12,0 | 115,0 | 6004756 | 5 |
| M 105 x 2,0 XXL | 12,0 | 115,0 | 6004757 | 5 |
| M 110 x 2,0 XXL | 12,0 | 125,0 | 6004758 | 1 |